



Studio Red Redcliffe SHS Artist in Residence (AIR) Proposal

Studio Options

- Studio 1 Red
- Studio 2 Green
- (May not always be available)
- Studio 3 Blue

Fixed infrastructure

The gallery space is fitted out with a gallery hanging system and fixed lighting. Successful applicants may use this space in negotiation to trial exhibitions. Toilet and kitchenette on site

Studios have:

- secured store (Green Space Exempt)
- Sinks with running water
- Benches, stools and wall storage.

Schedule

Residences are expect to be a semester (approx. 20 weeks) long however shorter residencies may be negotiated.

Points to consider

- Residency is within Redcliffe State High School Western Campus.
- Smoking and consumption of alcohol is forbidden on premises at all times.
- Artist must abide by rules, regulations, conventions and administrative practices of the school including WPHS regulations.
- Artist must hold a current "Working with Children" clearance (Blue Card).
- Artist will work with students and art teachers in a variety of formats.
- May develop an ongoing project with a class.
- No expectations that Artist will be in a student management role.
- Artist be "in-residence" for 50% of the school week or approximately 15 hours.
- Use of the studio space is for the artist's sole use during period of residency.

How to apply

- It is essential that all material requested on the application for be included.

Please ensure

- Your application is typed or clearly hand written using the application form and includes requested information.
- Support material is clearly marked and corresponds to the items listed on the application form.
- Examples of your previous works are included.
- Images supplied are of a JPEG format.
- Links to any relevant websites

Completed applications

Post or hand delivered to Redcliffe SHS P.O Box 510, Redcliffe, Q 4020 (Please include a self addressed envelope if you wish for your material to be sent back)

Emailed to:

studioed@redcliffeshs.eq.edu.au

Applications will be reviewed according to the availability of the exhibition space and the viability of the artist's practice within Redcliffe SHS's visual art curriculum.

Successful applicants

On notification of your acceptance Studio Red will enter into an agreement with individuals detailing the term set out in these documents

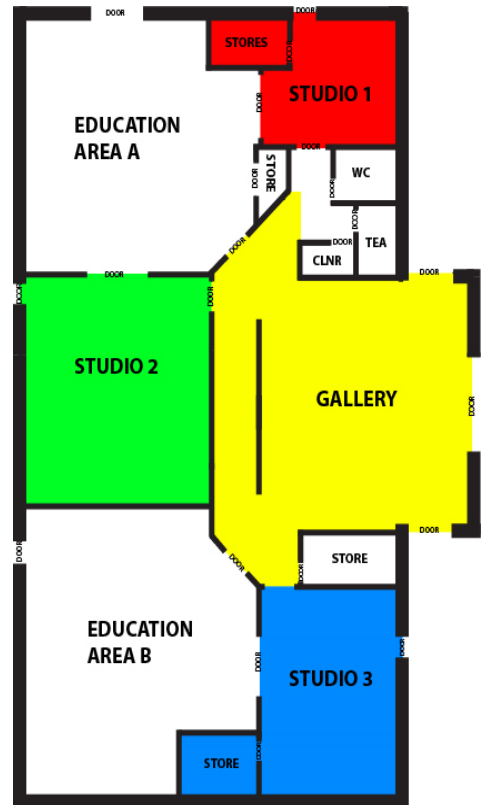

APPLICANT DETAILS

Name: _____

Post: _____

_____ P/C _____

Phone: _____ Mobile: _____

Email: _____

Studio (circle) 1 2 or 3

Medium: _____

Attached

- Description of practice
- Curriculum Vitae
- Photocopy of Blue Card or Blue Card Application
- 5 jpegs of own artwork
- Website links (if applicable)

Declaration

I submit this proposal for consideration in Studio Red's Artist in Residence Program. The work presented in this application is solely the artistic product of myself and does not knowingly infringe on the intellectual or moral rights of any other parties. I acknowledge that if my application is accepted that Studio Red – Redcliffe State High School will have the right to utilise documentation, visual and or written of the work in the promotion of the artist in residence and or program for this residency or future residencies. I am aware that the decision of the selection committee will be final and no correspondence will be entered into.

Date: _____

Sign: _____

(By signing here you agree to all of the details outlined in the document)

